

ITEM # Fabric: 12075

Pole Package: 11911

Stake & Ratchet: 16498

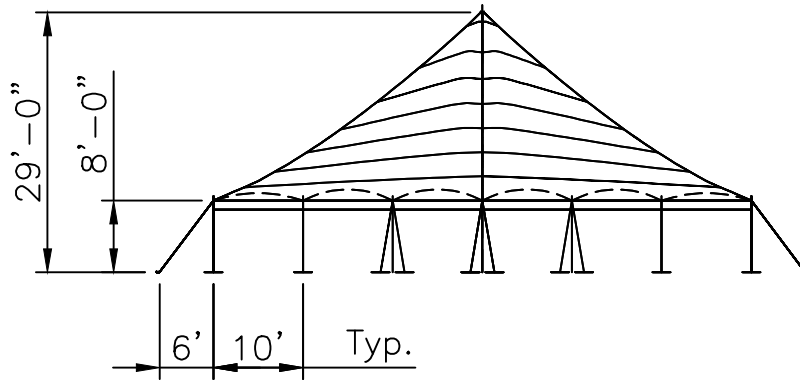

Side View

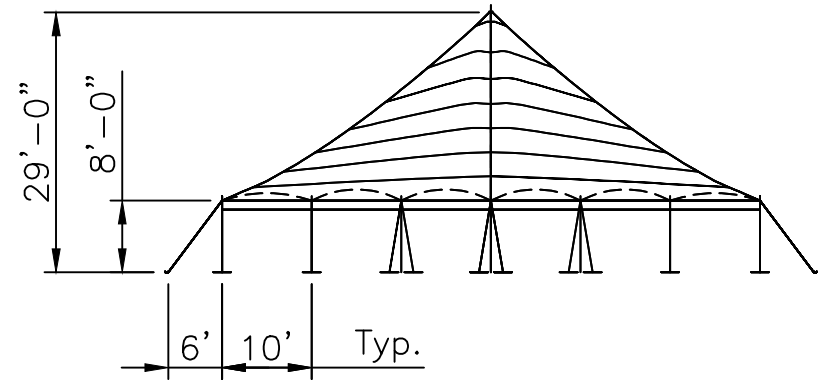

End View

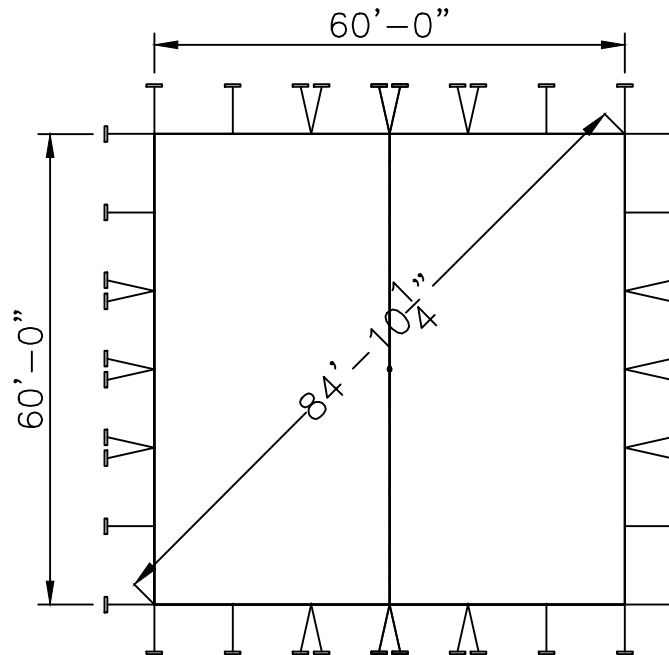

Top View

Std/Opt	Qty	Part#	Description
Standard 12075	2	12075-E	60'x30' End Section
Option A 11911	1	14135	29' - 6" Sch. 40 Alum Center Pole 2pc
	24	14270	8' - 2" Sch. 40 Alum Side Pole
Option B	1	14135-CH	29' - 6" Sch. 40 Alum Center Pole 2pc - Cherry Finish
	24	14270-CH	8' - 2" Sch. 40 Alum Side Pole - Cherry Finish
Option C	1	14135-KP	29' - 6" Sch. 40 Alum Center Pole 2pc - Pine Finish
	24	14270-KP	8' - 2" Sch. 40 Alum Side Pole - Pine Finish
Standard 16498	40	15245	Lashing Winch & Mounting Plate
	40	14874	Stake Bar
	40	14867	14' Web W/ Twisted Hook
	120	15228	1 1/8"x42" Dbl Headed Stakes

60x60 PT SE U

Fred's Standard
60 x 60 Series "SE"
Pole Tent

PROPRIETARY INFORMATION
THE DATA AND DETAILS SHOWN ON THIS PAGE ARE THE
SOLE PROPERTY OF FRED'S TENTS & CANOPIES. IT MAY
NOT BE USED, DISCLOSED, OR DUPLICATED IN ANY WAY.

FRED'S TENTS & CANOPIES

Waterford, NY 12188

www.wemaketents.com • 518.233.8368

DRAWN BY: MO	APP. BY: TV	APP. BY:	DATE: 9-26-16	LAST REV BY:
--------------	-------------	----------	---------------	--------------

ITEM # Fabric: 18100

Pole Package: 18102

Stake & Ratchet: 18104

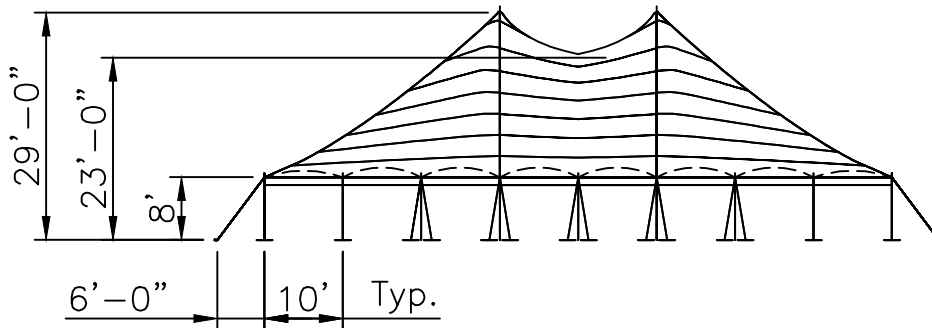

Side View

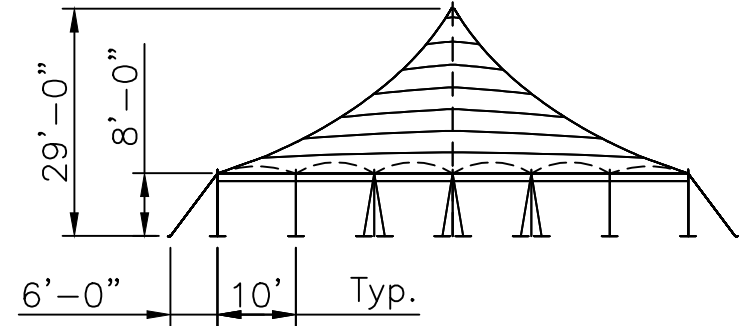

End View

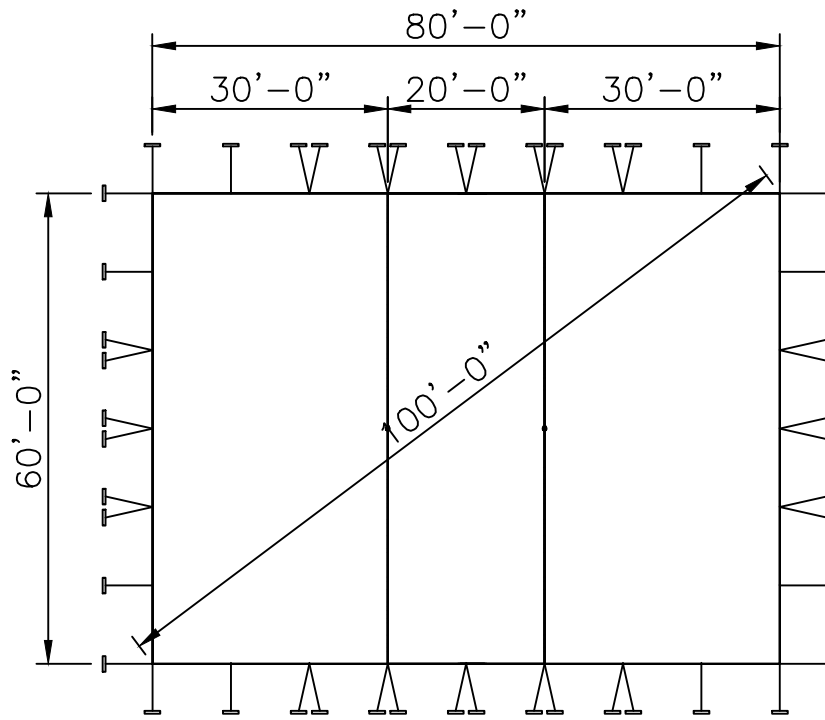

Top View

60x80 PT SE U

Fred's Standard
60 x 80 Series "SE"
Pole Tent

PROPRIETARY INFORMATION
THE DATA AND DETAILS SHOWN ON THIS PAGE ARE THE
SOLE PROPERTY OF FRED'S TENTS & CANOPIES. IT MAY
NOT BE USED, DISCLOSED, OR DUPLICATED IN ANY WAY.

FRED'S TENTS & CANOPIES

Waterford, NY 12188
www.wemaketents.com • 518.233.8368

Std/Opt	Qty	Part#	Description
Standard 18100	2	12075-E	60'x30' End Section
	1	12068	60'x20' Mid Section
Option A 18102	2	14135	29' - 6" Sch. 40 Alum Center Pole 2pc
	28	14270	8' - 2" Sch. 40 Alum Side Pole
Option B	2	14135-CH	29' - 6" Sch. 40 Alum Center Pole 2pc - Cherry Finish
	28	14270-CH	8' - 2" Sch. 40 Alum Side Pole - Cherry Finish
Option C	2	14135-KP	29' - 6" Sch. 40 Alum Center Pole 2pc - Pine Finish
	28	14270-KP	8' - 2" Sch. 40 Alum Side Pole - Pine Finish
Standard 18104	48	15245	Lashing Winch & Mounting Plate
	48	14874	Stake Bar
	48	14867	14' Web W/ Twisted Hook
	144	15228	1 1/8"x42" Dbl Headed Stakes

DRAWN BY: MO	APP. BY: TV	APP. BY:	DATE: 9-26-16	LAST REV BY:
--------------	-------------	----------	---------------	--------------

ITEM # Fabric: 12076

Pole Package: 11912

Stake & Ratchet: 11944

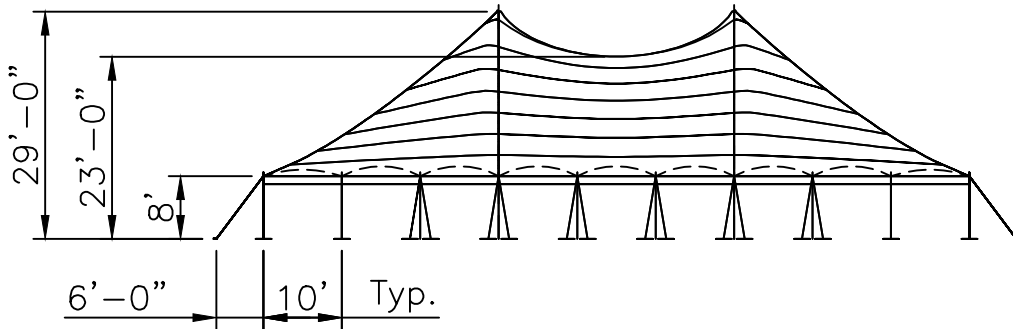

Side View

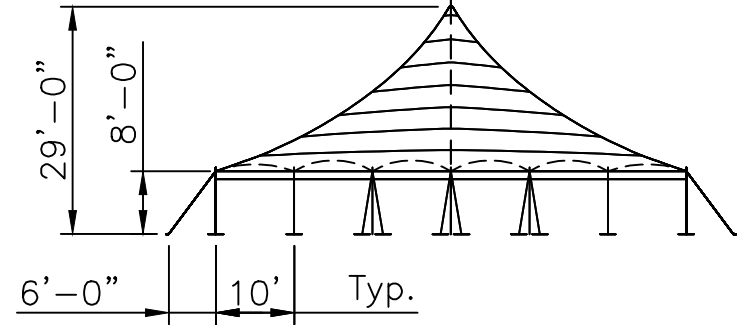

End View

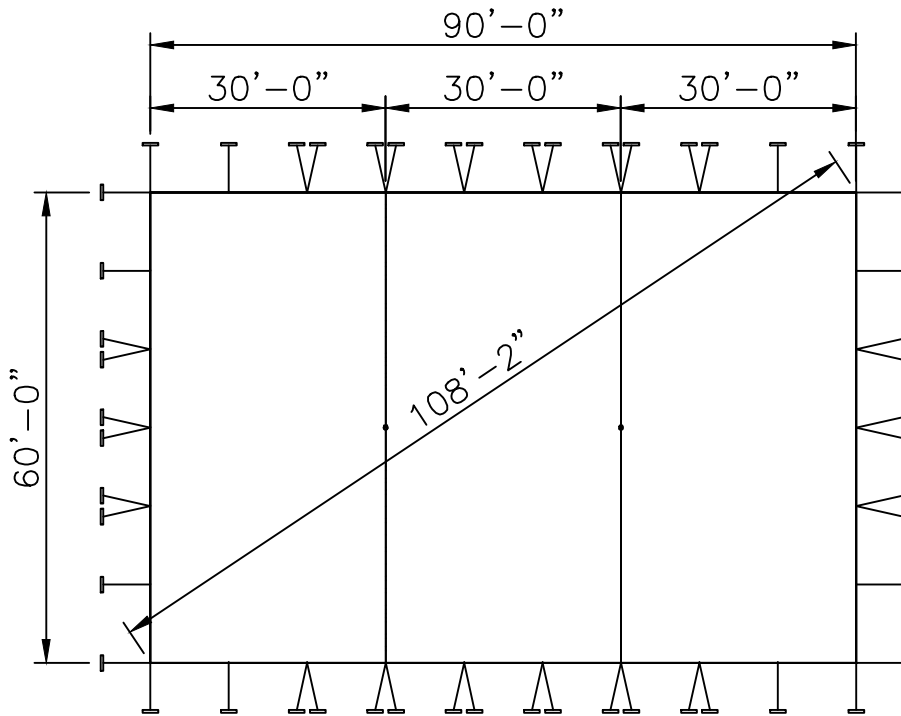

Top View

60x90 PT SE U

Std/Opt	Qty	Part#	Description
Standard 12076	2	12075-E	60'x30' End Section
	1	12069	60'x30' Mid Section
Option A 11912	2	14135	29' - 6" Sch. 40 Alum Center Pole 2pc
	30	14270	8' - 2" Sch. 40 Alum Side Pole
Option B	2	14135-CH	29' - 6" Sch. 40 Alum Center Pole 2pc - Cherry Finish
	30	14270-CH	8' - 2" Sch. 40 Alum Side Pole - Cherry Finish
Option C	2	14135-KP	29' - 6" Sch. 40 Alum Center Pole 2pc - Pine Finish
	30	14270-KP	8' - 2" Sch. 40 Alum Side Pole - Pine Finish
Standard 11944	52	15245	Lashing Winch & Mounting Plate
	52	14874	Stake Bar
	52	14867	14' Web W/ Twisted Hook
	156	15228	1 1/8"x42" Dbl Headed Stakes

Fred's Standard
60 x 90 Series "SE"
Pole Tent

PROPRIETARY INFORMATION
THE DATA AND DETAILS SHOWN ON THIS PAGE ARE THE
SOLE PROPERTY OF FRED'S TENTS & CANOPIES. IT MAY
NOT BE USED, DISCLOSED, OR DUPLICATED IN ANY WAY.

FRED'S TENTS & CANOPIES

Waterford, NY 12188
www.wemaketents.com • 518.233.8368

DRAWN BY: MO	APP. BY: TV	APP. BY:	DATE: 9-26-16	LAST REV BY:
--------------	-------------	----------	---------------	--------------

ITEM # Fabric: 18101

Pole Package: 18103

Stake & Ratchet: 18105

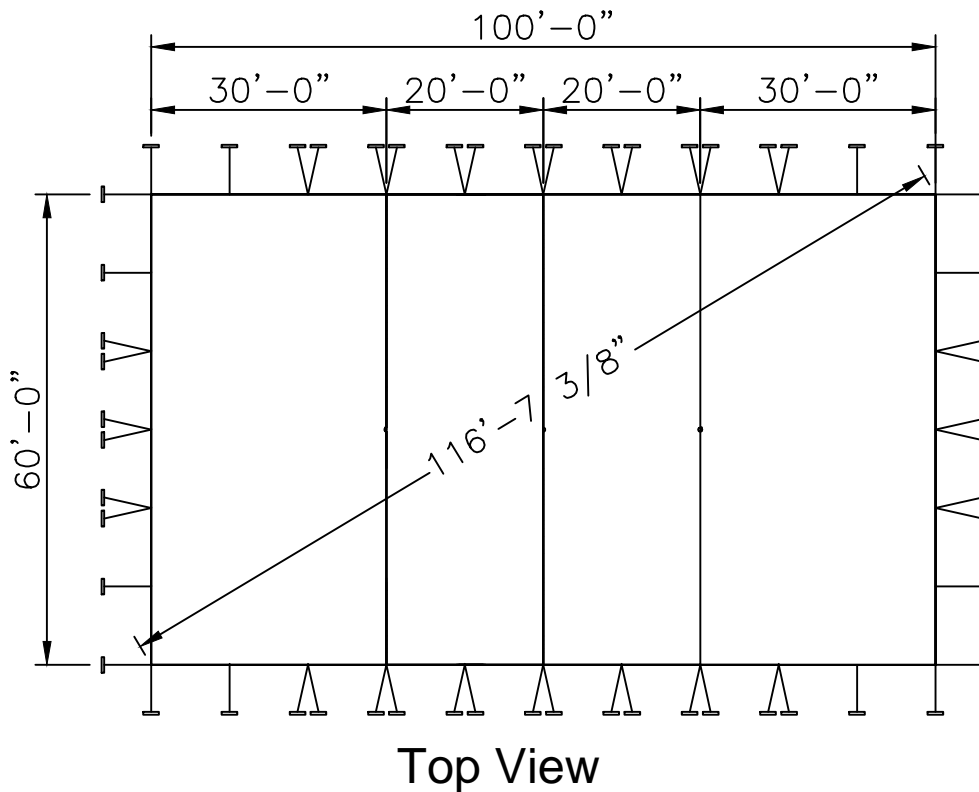
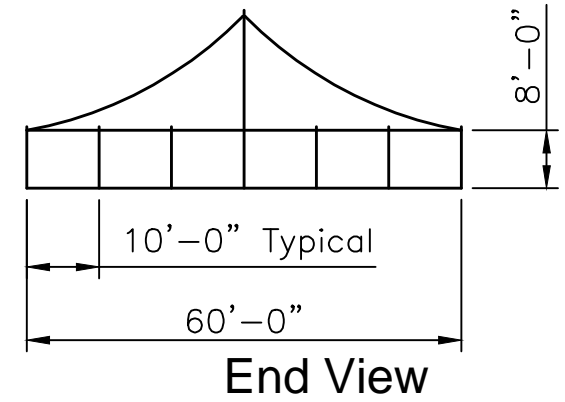
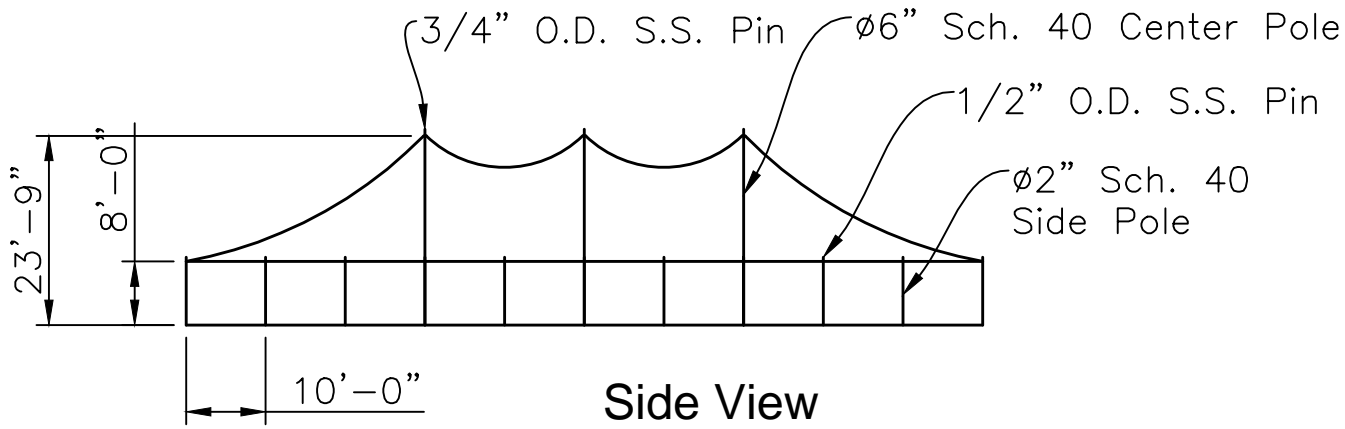

60x100 PT SE U

Std/Opt	Qty	Part#	Description
Standard 18101	2	12075-E	60'x30' End Section
	2	12068	60'x20' Mid Section
Option A 18103	3	14135	29' - 6" Sch. 40 Alum Center Pole 2pc
	32	14270	8' - 2" Sch. 40 Alum Side Pole
Option B	3	14135-CH	29' - 6" Sch. 40 Alum Center Pole 2pc - Cherry Finish
	32	14270-CH	8' - 2" Sch. 40 Alum Side Pole - Cherry Finish
Option C	3	14135-KP	29' - 6" Sch. 40 Alum Center Pole 2pc - Pine Finish
	32	14270-KP	8' - 2" Sch. 40 Alum Side Pole - Pine Finish
Standard 18105	56	15245	Lashing Winch & Mounting Plate
	56	14874	Stake Bar
	56	14867	14' Web W/ Twisted Hook
	168	15228	1 1/8"x42" Dbl Headed Stakes

Fred's Standard
60 x 100 Series "SE"
Pole Tent

PROPRIETARY INFORMATION
THE DATA AND DETAILS SHOWN ON THIS PAGE ARE THE
SOLE PROPERTY OF FRED'S TENTS & CANOPIES. IT MAY
NOT BE USED, DISCLOSED, OR DUPLICATED IN ANY WAY.

FRED'S TENTS & CANOPIES

Waterford, NY 12188
www.wemaketents.com • 518.233.8368

DRAWN BY: MO	APP. BY: TV	APP. BY:	DATE: 9-26-16	LAST REV BY:
--------------	-------------	----------	---------------	--------------

ITEM # Fabric: 12070

Pole Package: 11906

Stake & Ratchet: 13939

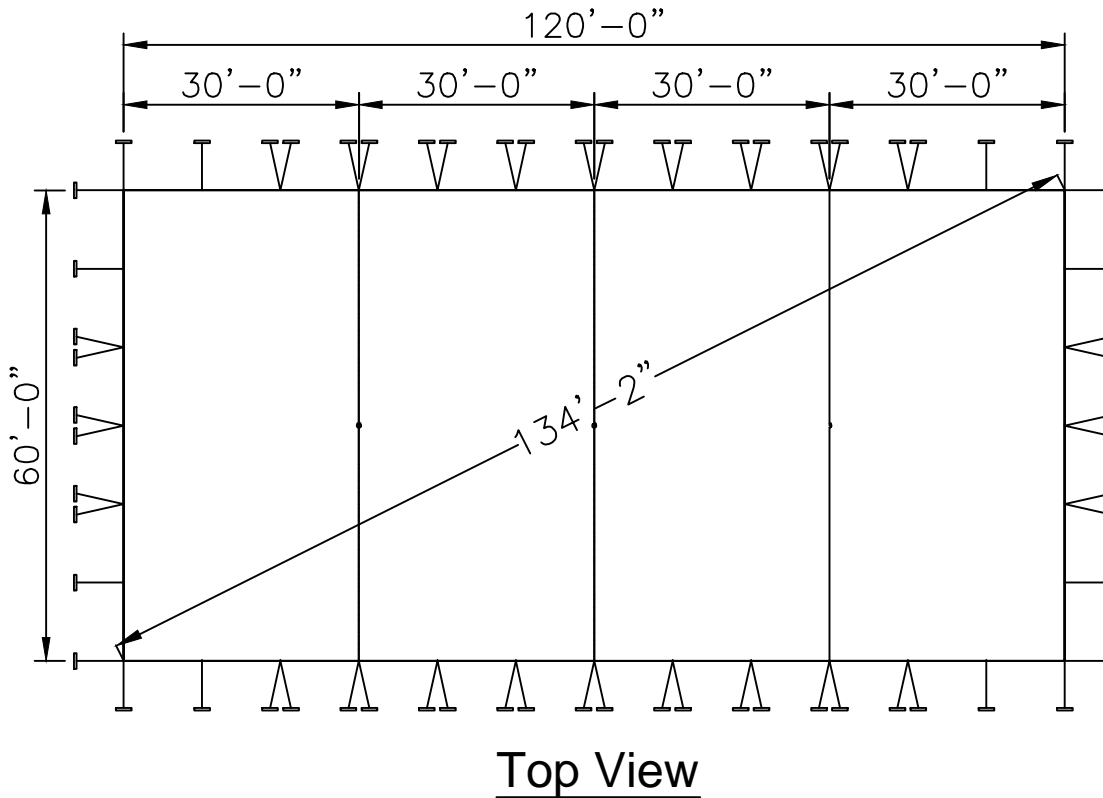
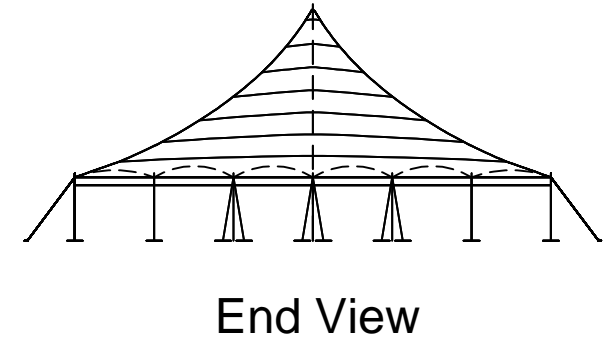
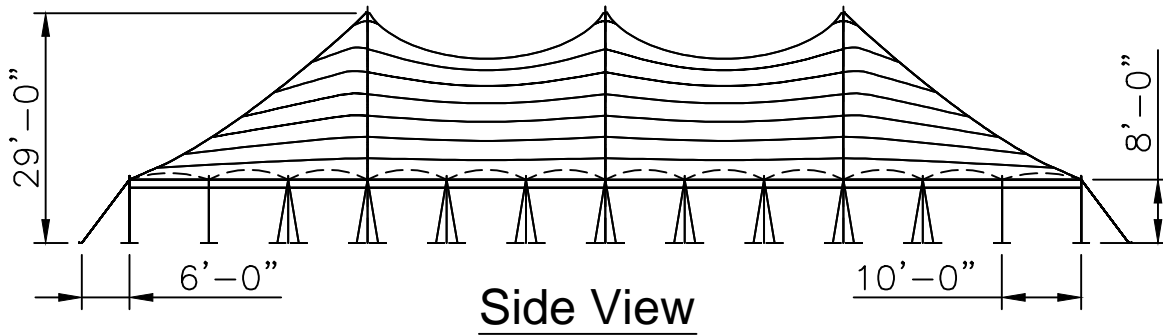

60x120 PT SE U

Std/Opt	Qty	Part#	Description
Standard 12070	2	12075-E	60'x30' End Section
	2	12069	60'x30' Mid Section
Option A 11906	3	14135	29' - 6" Sch. 40 Alum Center Pole 2pc
	36	14270	8' - 2" Sch. 40 Alum Side Pole
Option B	3	14135-CH	29' - 6" Sch. 40 Alum Center Pole 2pc - Cherry Finish
	36	14270-CH	8' - 2" Sch. 40 Alum Side Pole - Cherry Finish
Option C	3	14135-KP	29' - 6" Sch. 40 Alum Center Pole 2pc - Pine Finish
	36	14270-KP	8' - 2" Sch. 40 Alum Side Pole - Pine Finish
Standard 11939	64	15245	Lashing Winch & Mounting Plate
	64	14874	Stake Bar
	64	14867	14' Web W/ Twisted Hook
	192	15228	1 1/8"x42" Dbl Headed Stakes

Fred's Standard
60 x 120 Series "SE"
Pole Tent

PROPRIETARY INFORMATION
THE DATA AND DETAILS SHOWN ON THIS PAGE ARE THE
SOLE PROPERTY OF FRED'S TENTS & CANOPIES. IT MAY
NOT BE USED, DISCLOSED, OR DUPLICATED IN ANY WAY.

FRED'S TENTS & CANOPIES

Waterford, NY 12188

www.wemaketents.com • 518.233.8368

DRAWN BY: MO	APP. BY: TV	APP. BY:	DATE: 9-26-16	LAST REV BY:
--------------	-------------	----------	---------------	--------------

ITEM # Fabric: 12071

Pole Package: 11907

Stake & Ratchet: 11940

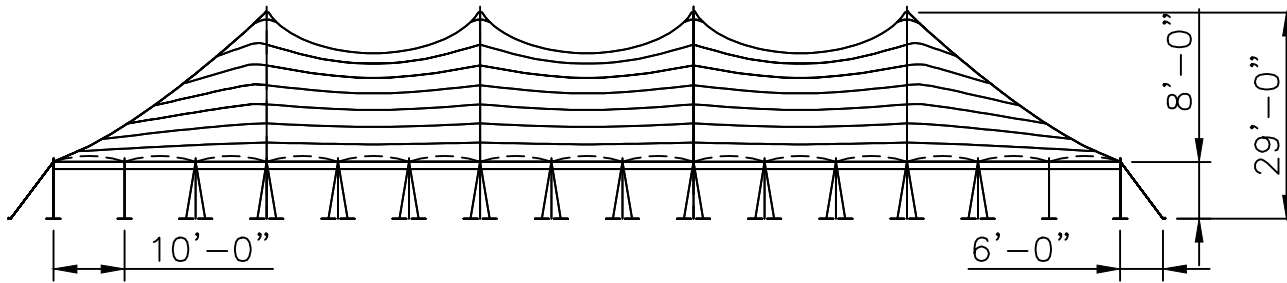

Side View

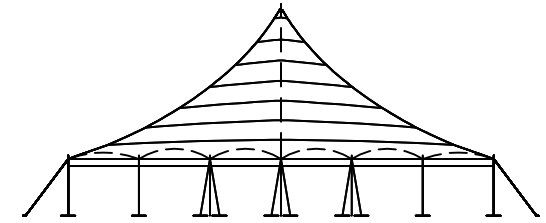

End View

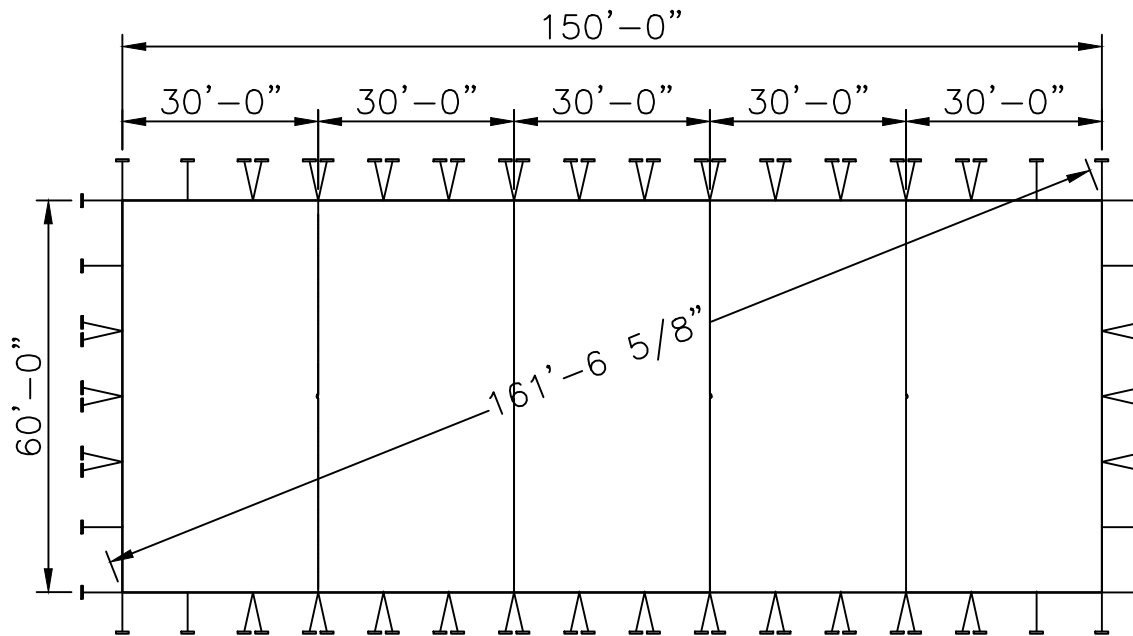

Top View

Std/Opt	Qty	Part#	Description
Standard 12071	2	12075-E	60'x30' End Section
	3	12069	60'x30' Mid Section
Option A 11907	4	14135	29' - 6" Sch. 40 Alum Center Pole 2pc
	42	14270	8' - 2" Sch. 40 Alum Side Pole
Option B	4	14135-CH	29' - 6" Sch. 40 Alum Center Pole 2pc - Cherry Finish
	42	14270-CH	8' - 2" Sch. 40 Alum Side Pole - Cherry Finish
Option C	4	14135-KP	29' - 6" Sch. 40 Alum Center Pole 2pc - Pine Finish
	42	14270-KP	8' - 2" Sch. 40 Alum Side Pole - Pine Finish
Standard 11940	76	15245	Lashing Winch & Mounting Plate
	76	14874	Stake Bar
	76	14867	14' Web W/ Twisted Hook
	228	15228	1 1/8"x42" Dbl Headed Stakes

60x150 PT SE U

Fred's Standard
60 x 150 Series "SE"
Pole Tent

PROPRIETARY INFORMATION

THE DATA AND DETAILS SHOWN ON THIS PAGE ARE THE SOLE PROPERTY OF FRED'S TENTS & CANOPIES. IT MAY NOT BE USED, DISCLOSED, OR DUPLICATED IN ANY WAY.

FRED'S TENTS & CANOPIES

Waterford, NY 12188
www.wemaketents.com • 518.233.8368

DRAWN BY: MO	APP. BY: TV	APP. BY:	DATE: 9-26-16	LAST REV BY:
--------------	-------------	----------	---------------	--------------

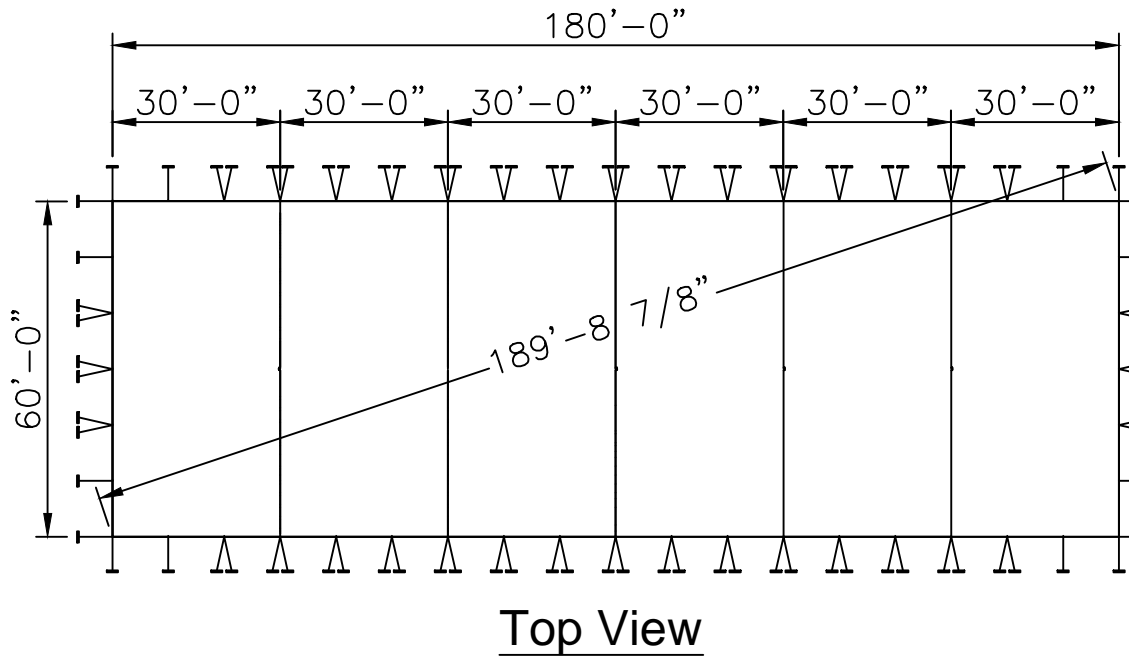
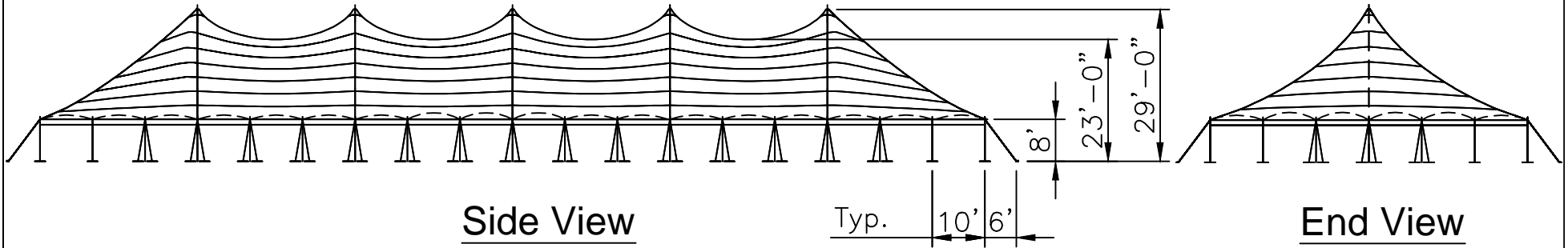

Std/Opt	Qty	Part#	Description
Standard 12072	2	12075-E	60'x30' End Section
	4	12069	60'x30' Mid Section
Option A 11908	5	14135	29' - 6" Sch. 40 Alum Center Pole 2pc
	48	14270	8' - 2" Sch. 40 Alum Side Pole
Option B	5	14135-CH	29' - 6" Sch. 40 Alum Center Pole 2pc - Cherry Finish
	48	14270-CH	8' - 2" Sch. 40 Alum Side Pole - Cherry Finish
Option C	5	14135-KP	29' - 6" Sch. 40 Alum Center Pole 2pc - Pine Finish
	48	14270-KP	8' - 2" Sch. 40 Alum Side Pole - Pine Finish
Standard 11941	88	15245	Lashing Winch & Mounting Plate
	88	14874	Stake Bar
	88	14867	14' Web W/ Twisted Hook
	264	15228	1 1/8"x42" Dbl Headed Stakes

60x180 PT SE U

Fred's Standard
60 x 180 Series "SE"
Pole Tent

PROPRIETARY INFORMATION
THE DATA AND DETAILS SHOWN ON THIS PAGE ARE THE
SOLE PROPERTY OF FRED'S TENTS & CANOPIES. IT MAY
NOT BE USED, DISCLOSED, OR DUPLICATED IN ANY WAY.

FRED'S TENTS & CANOPIES

Waterford, NY 12188
www.wemaketents.com • 518.233.8368

DRAWN BY: MO	APP. BY: TV	APP. BY:	DATE: 9-26-16	LAST REV BY:
--------------	-------------	----------	---------------	--------------